

# Fusion

Self-Service Refrigerated Open Reach-In - 72"H

Structural Concepts®  
DELIVERING FRESH. ALWAYS.™

- (Lengths do not include 1-1/8" end panels)
- MD472R

• MD672R

• MD872R

48"L x 37-1/8"D x 72-1/2"H

72"L x 37-1/8"D x 72-1/2"H

96"L x 37-1/8"D x 72-1/2"H

Included

- Integrated average product temperature of 40°F or less
- LED top & shelf lights
- One year parts & labor warranty
- Open reach-in front
- Remote DX refrigeration
- Stainless steel rear exterior



MD472R

Specify	Standard Features	Additional Options
EXTERIOR COLOR	• Powder coated Silversan Black	• Powder coated (stock/non-stock colors)
INTERIOR COLOR	• Powder coated Silversan Black	• Stainless steel
LOWER FRONT PANEL COLOR	• Powder coated Silversan Black	• Powder coated (stock/non-stock colors) • Stainless steel
BASE SUPPORT	• Rail system for shims	
BUMPER FRONT	• 1" Boston bumper (specify color)	• 1" Stainless steel plate rail bumper
END PANELS	• Full w/stainless steel mirror interior	• Cutaway w/glass • None (specify per line-up)
HEADER	• Flat header	
PRICE TAG MOLDING	• None	• Universal price tag molding (clear w/ open top)
REAR DOORS	• None (solid back panel)	• Solid rear swinging door(s) w/lock
SHELVING	• (4) Lighted clear glass shelves	• (5) Lighted clear glass shelves
LIGHTS	• LED 3500K w/ frosted lens	
ELECTRICAL CONNECTION	• Electrical leads (remote)	
REFRIGERATION	• Remote DX refrigeration	• Remote w/thermostat, solenoid & TXV
SENSOR	• None	• CPC discharge air sensor (remote)
MISCELLANEOUS		• Second year parts & labor warranty

# Fusion

Self-Service Refrigerated Open Reach-In - 72"H

Structural Concepts®

DELIVERING FRESH. ALWAYS.™

**Intended Environment:** Type I - Designed to operate in ambient conditions of 75°F with 55% relative humidity unless noted otherwise in system information below.

Zone	Intended Product To Be Displayed	Warmest Avg Prod Temp ° F
1	Packaged / unpackaged refrigerated products	40

PLAN VIEW

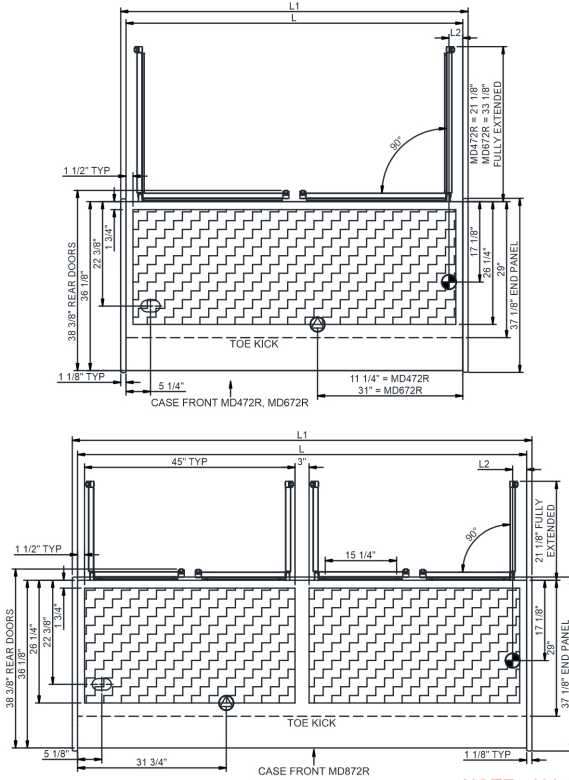

SIDE VIEW

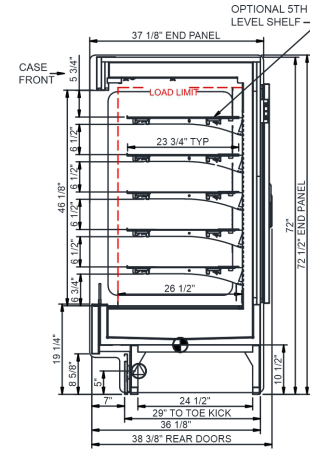

REAR DOORS LOADING SPACE		
MODEL	WD	HT x QTY
MD472R	17"	47 3/4" x 2
MD672R	27 1/8"	47 3/4" x 2
MD872R	17"	47 3/4" x 4

NOTE: ALL DIMENSIONS APPROXIMATE

- ELECTRICAL JUNCTION BOX (SUPPLIED WITH 6" LEADS OR POWER CORD).
- LOCATION OF DRAIN TUBE FOR REMOTE REF. ONLY (SUPPLIED WITH 3/4" OR 1 1/2" PVC TUBE).

- REFRIGERATION LINE CONNECTION.
- REMOTE FLOOR SINK & UTILITIES ACCESS AREA.

- SELF-CONTAINED CASE SERVICE ACCESS AREA.
- DRY CASE SERVICE ACCESS AREA.

Model Technical Specifications

Model	L"	L1"	L2"	System Circuit Volts			Phs	Freq	Amps ***	Watts	Wires	NEMA Plug	SST	Conv. Rack RTU/H	Para. Rack RTU/H	Est Wt
MD472R	48.00	50.25	3.00	Remote (DX)	Circuit #1	110-120	1	60	2.50	149	2+G	Leads Multiple	20.00	5184	4800	900
				Remote (GLYCOL 35%)	Circuit #1	110-120	1	60	2.42	139	2+G	Leads Multiple	20.00	5184	4800	
MD672R	72.00	74.25	3.00	Remote (DX)	Circuit #1	110-120	1	60	2.64	147	2+G	Leads Multiple	20.00	9072	8400	1,250
				Remote (GLYCOL 35%)	Circuit #1	110-120	1	60	2.56	163	2+G	Leads Multiple	20.00	9072	8400	
				Remote (R744 TRANSCRIT	Circuit #1	110-120	1	60	2.64	147	2+G	Leads Multiple	20.00	9072	8400	
MD872R	96.00	98.25	3.00	Remote (DX)	Circuit #1	110-120	1	60	4.48	282	2+G	Leads Single	24.00	12312	11400	1,600

\*\*\* Does not include electric defrost on freezer models.

## Regulatory Approvals:

All Models  
 Accordance with AHRI Std 1200  
 ETL Listed to UL 471  
 ETL Listed to CAN/CSA 22.2 No. 120  
 ETL Sanitation to NSF/ANSI 7



In Accordance with  
**AHRI Std 1200**

**DOE 2017**  
 Energy Efficiency  
 Compliant

## Important Notes:

1) Units must be shimmed during installation to ensure the unit is level and plumb.

**WARNING:** This product can expose you to chemicals, including Urethane (Ethyl Carbamate), which are known to the State of California to cause cancer and birth defects or other reproductive harm. For more information go to [www.P65Warnings.ca.gov](http://www.P65Warnings.ca.gov).