

# Technical Information

Reveal® - Combination Convertible Service Above Refrigerated Self-Service Case

Structural Concepts®

DELIVERING FRESH. ALWAYS.™

## DIMENSIONS / SHIPPING

Model	L"	L1"	L2"	Est Wt (lbs)
NR3658RRSSV	N/A	35.750	7.500	N/A
NR4858RRSSV	N/A	47.750	7.500	N/A
NR6058RRSSV	N/A	59.750	7.500	N/A

## ELECTRICAL

Model	System Circuit Volts			Ph	Frq	Rated Load Amps	Min Cir Amps	Max OCP Amps	Watts	Wires	NEMA Plug	Amps Lights	Amps Fans	Amps Anti-Sweats	Amps Misc/Refrig/Heat
NR3658RRSSV	Remote (DX)	Circuit #1	110-120	1	60	1.67	15	15	88	2+G	Leads Single	0.70	0.60	0.29	0.08
	Remote (DX)	Circuit #1	110-120	1	60	1.67	15	15	88	2+G	Leads Single	0.70	0.60	0.29	0.08
	Remote (R744 T)	Circuit #1	110-120	1	60	1.67	15	15	88	2+G	Leads Single	0.70	0.60	0.29	0.08
	Remote (R744 T)	Circuit #1	110-120	1	60	1.67	15	15	88	2+G	Leads Single	0.70	0.60	0.29	0.08
	Self-Contained (R290)	Circuit #1	110-120	1	60	15.27	20	20	1,530	2+G	5-20P or L5-20P	N/A	0.45	4.20	10.62
NR4858RRSSV	Remote (DX)	Circuit #1	110-120	1	60	1.74	15	15	104	2+G	Leads Single	0.70	0.60	0.36	0.08
	Remote (DX)	Circuit #1	110-120	1	60	1.74	15	15	104	2+G	Leads Single	0.70	0.60	0.36	0.08
	Self-Contained (R290)	Circuit #1	208-240	1	60	16.00	20	20	2,821	2+G	6-20P or L6-20P	N/A	0.44	3.59	13.36
NR6058RRSSV	Remote (DX)	Circuit #1	110-120	1	60	1.85	15	15	123	2+G	Leads Single	0.70	0.60	0.47	0.08
	Remote (DX)	Circuit #1	110-120	1	60	1.85	15	15	123	2+G	Leads Single	0.70	0.60	0.47	0.08
	Self-Contained (R290)	Circuit #1	208-240	1	60	16.00	20	20	2,844	2+G	6-20P or L6-20P	N/A	0.44	3.63	13.36

## REFRIGERATION

Model	Zone	Section	System	Env't	REMOTE REFRIGERATION					GLYCOL / R744 REFRIGERATION			
					SST (°F)	Conv. Rack BTUH	Para. Rack BTUH	Defrost Interval (Hrs)	Defrost Duration	Total GPM	Pressure Drop (psi)	Concent (%)	Liquid Temp (°F)
NR3658RRSSV	All	Refrigerator	Remote-DX	Type II	20	2,894	2,680	4.00	30.00	N/A	N/A	N/A	N/A
	All	Refrigerator	Remote-DX	Type I	20	2,376	2,200	4.00	30.00	N/A	N/A	N/A	N/A
	All	Refrigerator	Remote-R744 TRANSCRITICAL	Type I	20	2,376	2,200	4.00	30.00	N/A	N/A	N/A	N/A
	All	Refrigerator	Remote-R744 TRANSCRITICAL	Type II	20	2,894	2,680	4.00	30.00	N/A	N/A	N/A	N/A
	All	Main	Self-Contained-R290	Type II	N/A	N/A	N/A	N/A	N/A	N/A	N/A	N/A	N/A
NR4858RRSSV	All	Refrigerator	Remote-DX	Type II	20	3,802	3,520	4.00	30.00	N/A	N/A	N/A	N/A
	All	Refrigerator	Remote-DX	Type I	20	3,110	2,880	4.00	30.00	N/A	N/A	N/A	N/A
	All	Main	Self-Contained-R290	Type II	N/A	N/A	N/A	N/A	N/A	N/A	N/A	N/A	N/A
NR6058RRSSV	All	Refrigerator	Remote-DX	Type II	20	4,730	4,380	4.00	30.00	N/A	N/A	N/A	N/A
	All	Refrigerator	Remote-DX	Type I	20	3,888	3,600	4.00	30.00	N/A	N/A	N/A	N/A
	All	Main	Self-Contained-R290	Type II	N/A	N/A	N/A	N/A	N/A	N/A	N/A	N/A	N/A

## INTENDED ENVIRONMENT

Type II - Designed to operate in ambient conditions of 80°F and 55% relative humidity unless noted otherwise under Env't above.

## WARMEST AVERAGE PRODUCT TEMP & INTENDED USE OF ZONES

Zone	Temp (°F)	Intended Use
1	40	Packaged / unpackaged refrigerated products

## REGULATORY

All Models	Accordance with AHRI Std 1200 ETL Listed to UL 471 ETL Listed to CAN/CSA 22.2 No. 120 ETL Sanitation to NSF/ANSI 7
------------	---

## IMPORTANT NOTES

- 1) ELECTRICAL NOTE: If GFCI is required, a GFCI breaker MUST be used in lieu of a GFCI receptacle.
- 2) Glass warranty only applicable to first point of delivery.
- 3) Compressor air intake from rear and out front panel at toe kick. Front panel cannot be blocked.



In Accordance with  
**AHRI Std 1200**

## Reveal® - Combination Convertible Service Above Refrigerated Self-Service Case

## Structural Concepts®

DELIVERING FRESH. ALWAYS.™

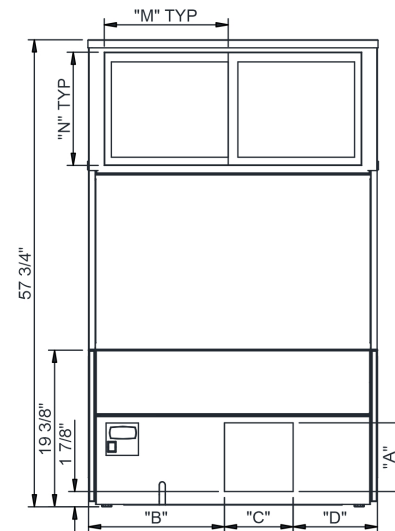
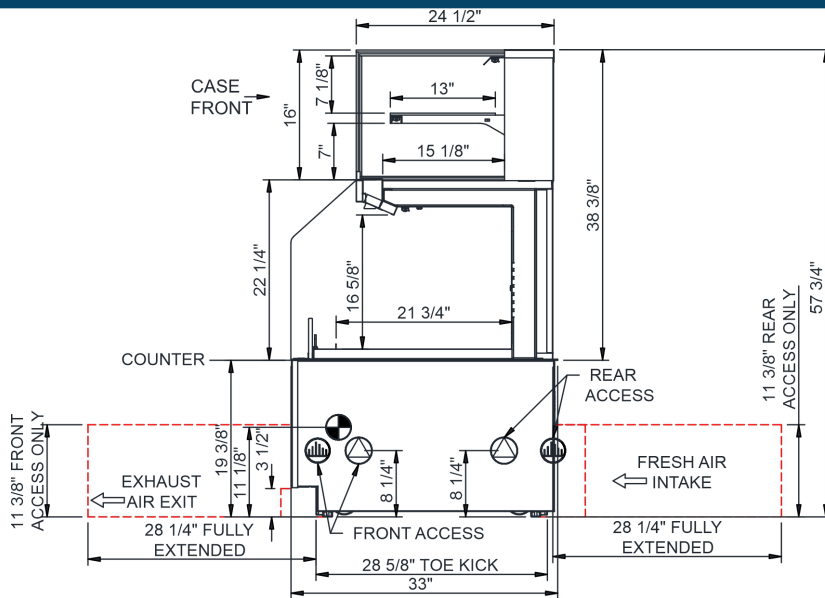

REAR VIEW

NOTES:

1. 11 3/8" TALL, FULL WIDTH OF CASE OPENING IN CABINET OR COUNTER IS REQUIRED TO PULL OUT REFRIGERATION SYSTEM.
2. BACK OF COUNTER / CABINET MUST BE VENTED PROPERLY FOR ADEQUATE AIRFLOW TO CONDENSER.
3. \*\*REPRESENTS REAR PULLOUT REFRIGERATION. AIR FLOW INTAKE AND EXIT DETAILS ARE REVERSED WITH FRONT PULLOUT REFRIGERATION OPTION.
4. SELF-CONTAINED ACCESS ONLY BY PULLING OUT CONDENSER UNIT.
5. 4" OPEN AREA CLEARANCE REQUIRED FOR AIR FLOW FRONT AND REAR OF CASE.

	"A"	"B"	"C"	"D"		"M"	"N"
NR3658RRSSV	8 1/2"	16 7/8"	8 1/2"	10 1/2"	NR3658RRSSV	14 1/2"	13 7/8"
NR4858RRSSV	8 1/2"	13 3/4"	8 1/2" x2	10 1/2"	NR4858RRSSV	20 1/2"	13 7/8"
NR6058RRSSV	8 1/2"	19 1/2"	8 1/2" x2	10 1/2"	NR6058RRSSV	26 1/2"	13 7/8"

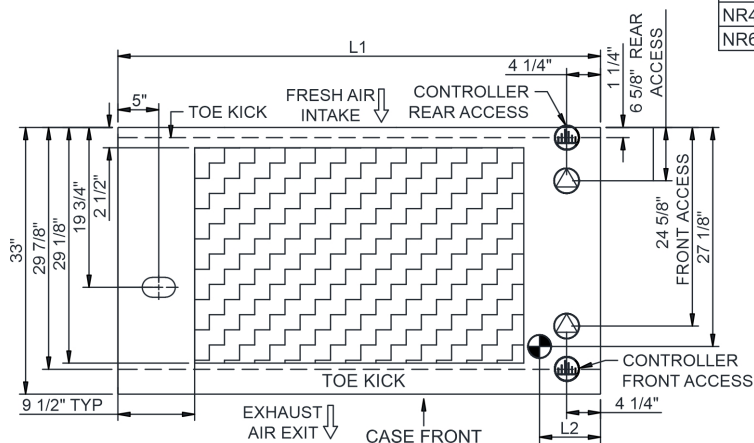

NOTE: ALL DIMENSIONS APPROXIMATE

