

Reveal[®] FIELD SERVICE PARTS LIST

FIELD SERVICE PARTS LIST

- > FOR REVEAL[®] SLIDE-IN SERVICE HEATED MERCHANDISERS UNITS
- > MODELS NE[L][H]HSV (SEE NEXT PAGE FOR APPLICABLE MODELS)

**SCC P/N
21-21279**

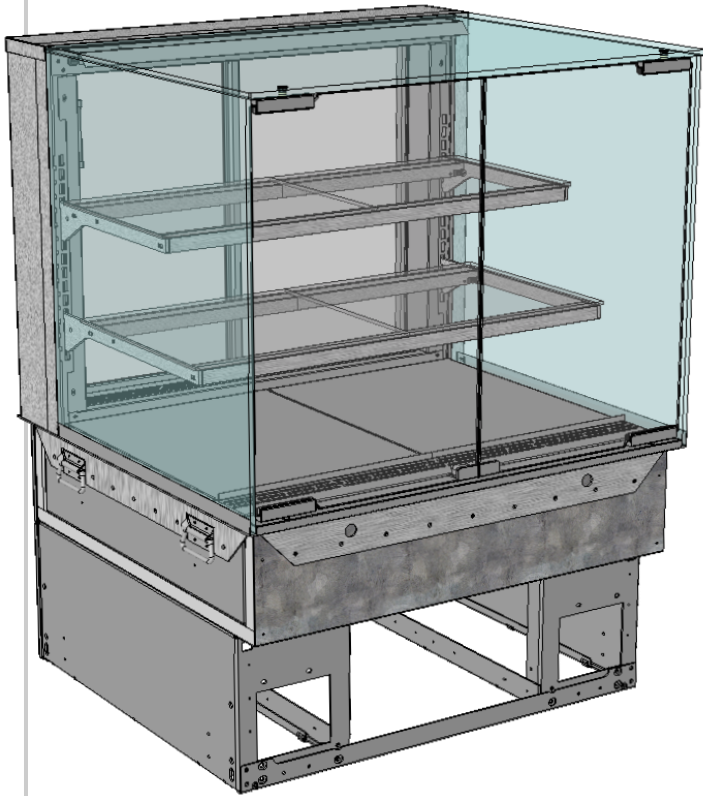

Model NE3627HSV Slide-In Unit Shown With
Dual Shelves (Your Unit May Vary)

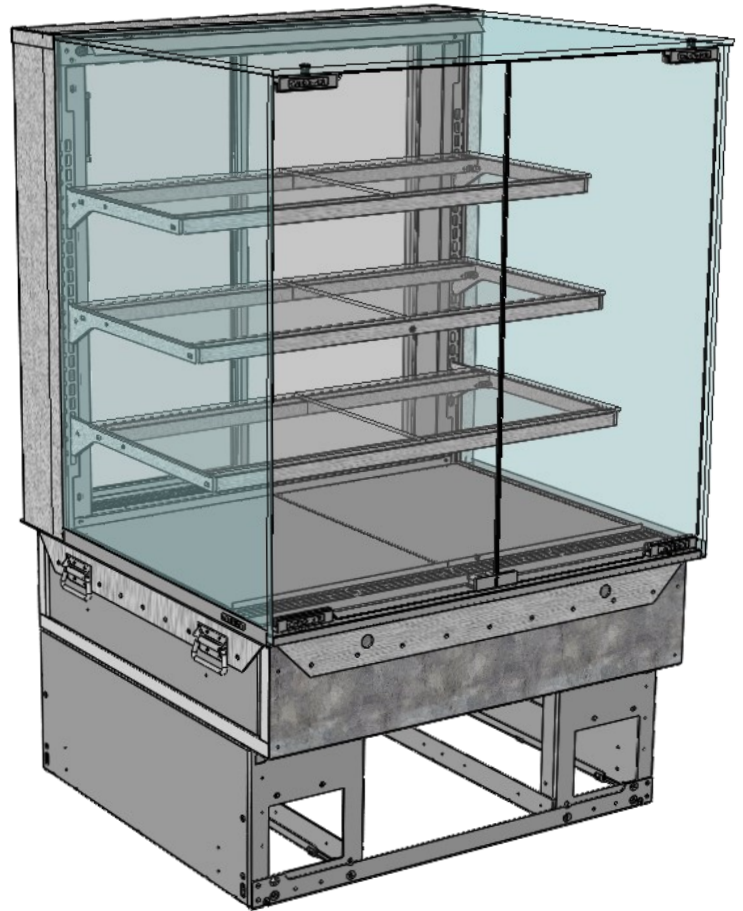

Model NE3635HSV Slide-In Unit Shown With
Three Shelves (Your Unit May Vary)

**See SCC P/N 21-20981 For This
Model's Operating Manual.**

**Important: You Must Have Model
Number and Serial Number
Ready When Calling SCC's
Technical Service. See Serial
Label For Complete Information.**

Structural Concepts[®]

DELIVERING FRESH. ALWAYS.™

Structural Concepts Corp. · 888 E. Porter Rd · Muskegon, MI 49441 Phone: 231.798.8888 Fax: 231.798.4960 · www.structuralconcepts.com

Illustrated Parts Breakdown Model Applicability and Size

Model	Upper Display Height	Overall Height	Case Depth x Length
NE3613HSV	13 5/8"UDH	32 7/8"OH	33"D x 35 3/4"L
NE3620HSV	20 3/8"UDH	39 5/8"OH	33"D x 35 3/4"L
NE3627HSV	27 7/8"UDH	47 1/8"OH	33"D x 35 3/4"L
NE3635HSV	35 1/4"UDH	54 5/8"OH	33"D x 35 3/4"L
NE4813HSV	13 5/8"UDH	32 7/8"OH	33"D x 47 3/4"L
NE4820HSV	20 3/8"UDH	39 5/8"	33"D x 47 3/4"L
NE4827HSV	27 7/8"UDH	47 1/8"OH	33"D x 47 3/4"L
NE4835HSV	35 1/4"UDH	54 5/8"OH	33"D x 47 3/4"L

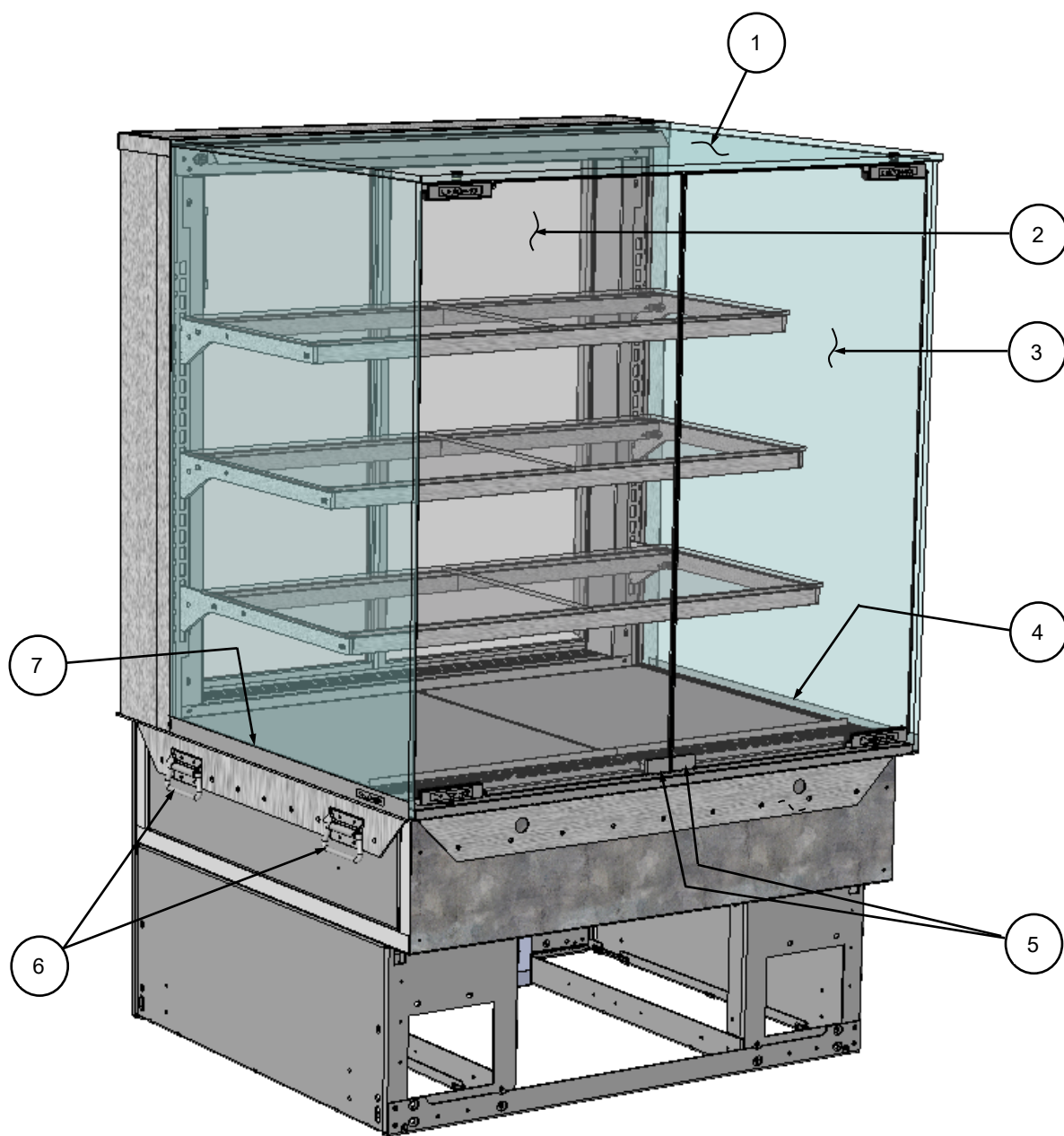

1	Glass Enclosure, UV-Bonded Assembly	5	Strike Plates (For Magnetic Door Latch)
2	Left Glass Door (Including Hinge Hardware)	6	Case Handles (Typ.)
3	Right Glass Door (Including Hinge Hardware)	7	Lower-Left Side Trim
4	Lower-Right Side Trim	8	

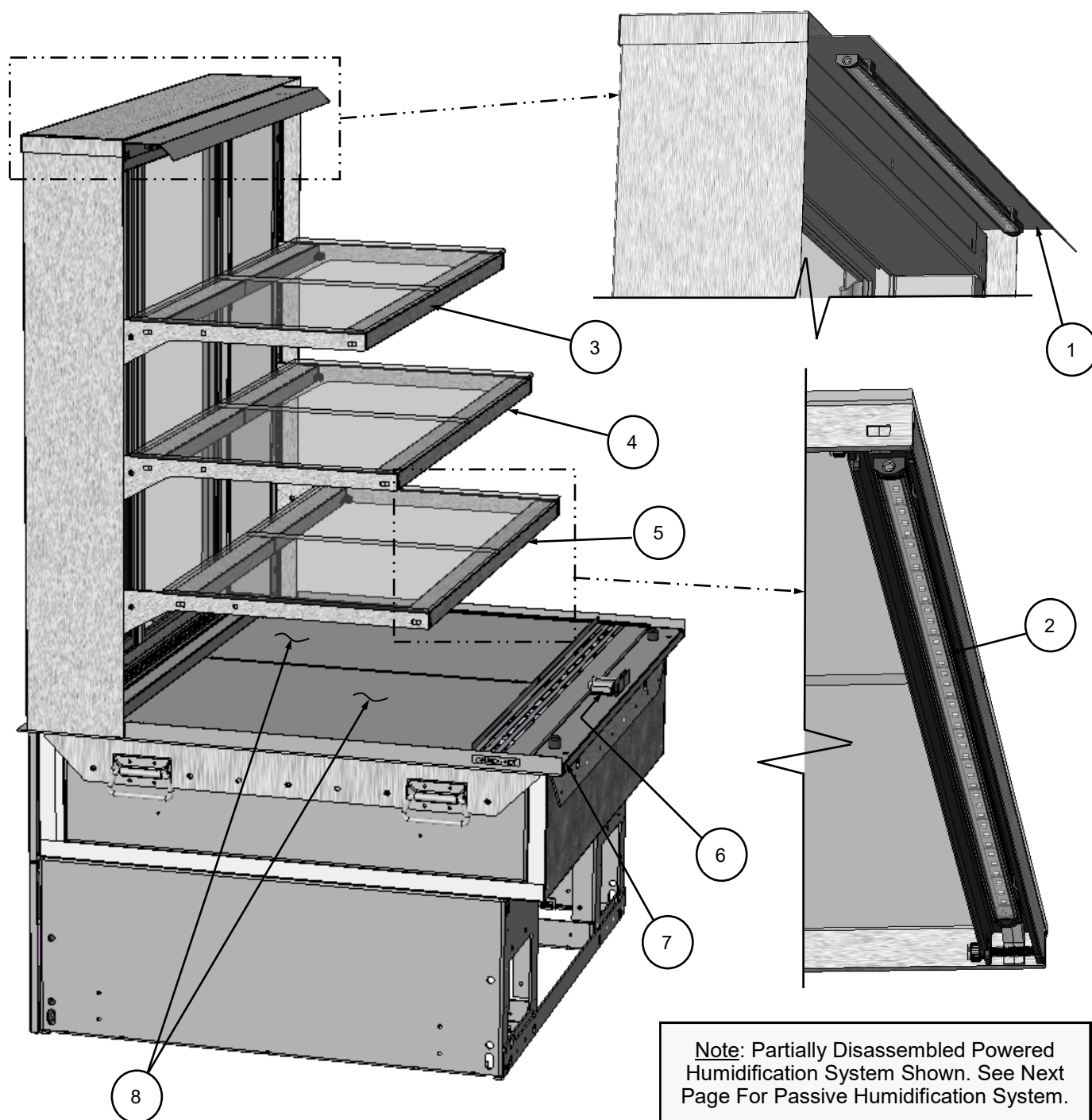

1	Top Lamp Shield	5	Lower Shelf Assembly
2	LED Lamp (Typ.)	6	Magnetic Door Latch (For Front Glass Doors), Typ.
3	Top Shelf Assembly	7	Stop (For Front Glass Doors) Typ.
4	Middle Shelf Assembly	8	Decking (Typ.)

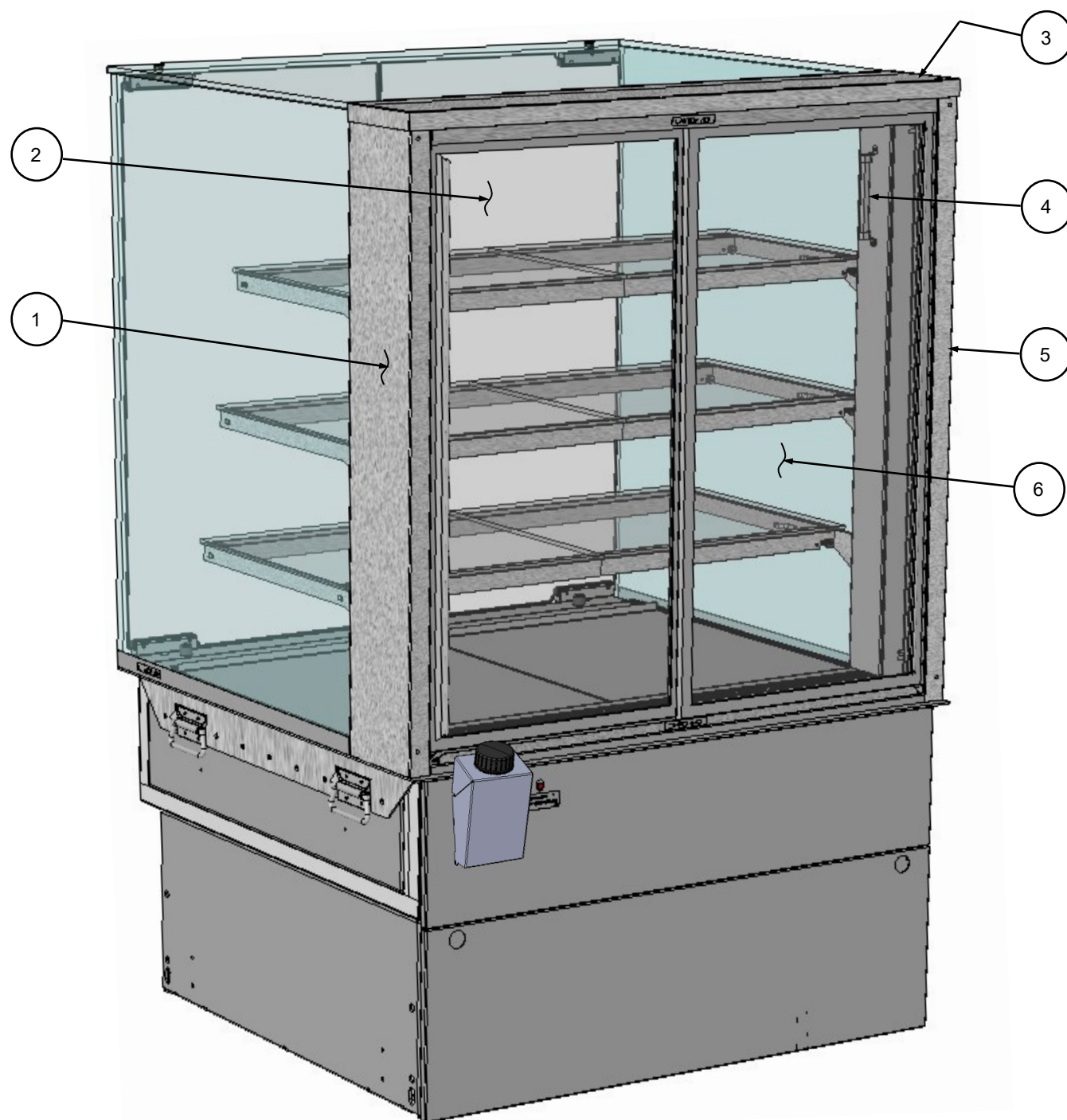

1	Rear Trim, RH	5	Rear Trim, LH
2	Left-Rear Sliding Door	6	Right-Rear Sliding Door
3	Top Trim	7	
4	Spirit Thermometer	8	

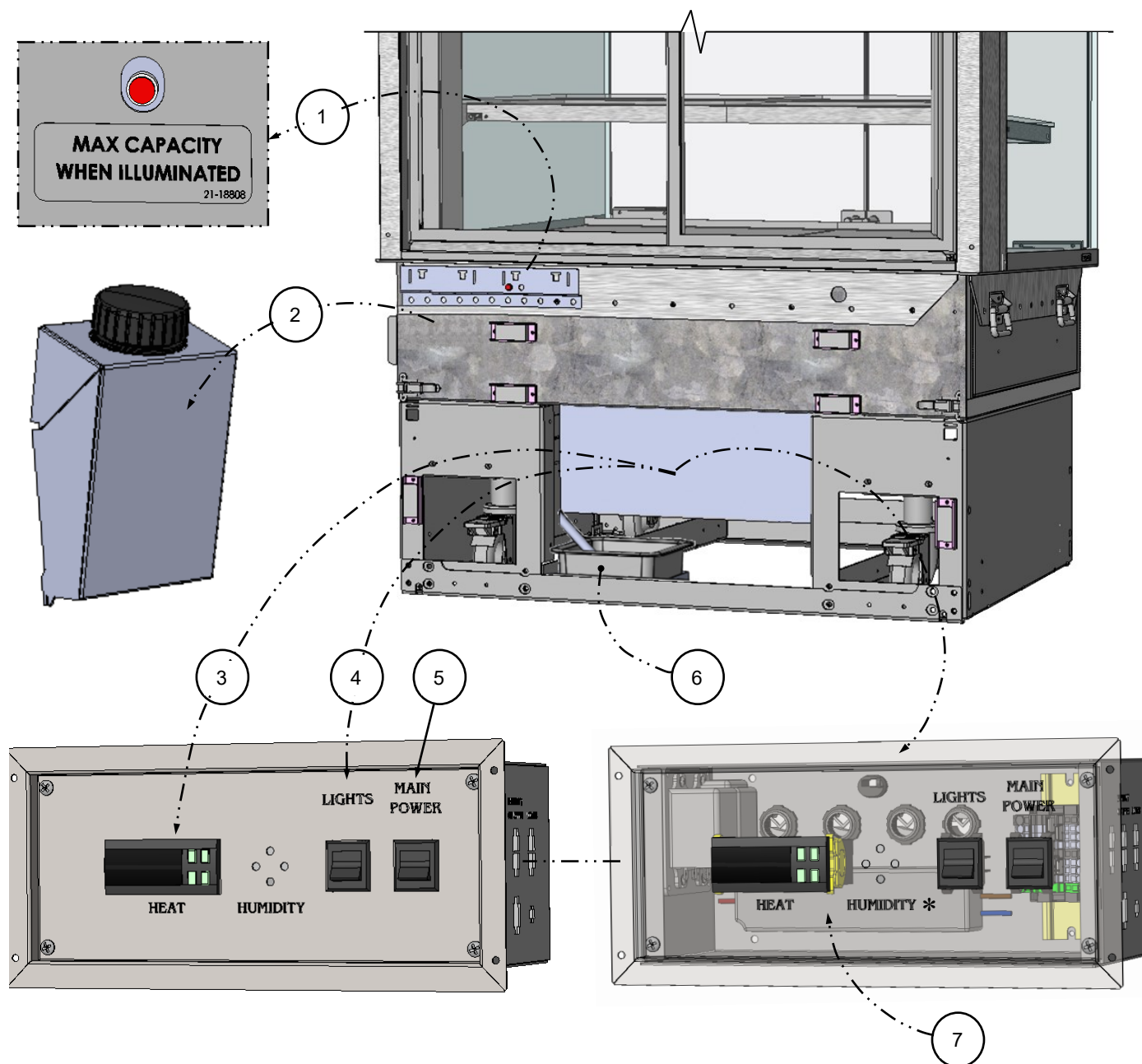

1	Maximum Capacity Sensor/LED	5	Main Power Switch
2	Water Fill Funnel	6	Overflow (For Optional Powered or Humidification Systems Only)
3	Heater Thermostat	7	LED Driver
4	Lights Switch	8	

***Note:** If "HUMIDITY" etching is on faceplate, simply ignore; such markings are not applicable to cases in this manual.

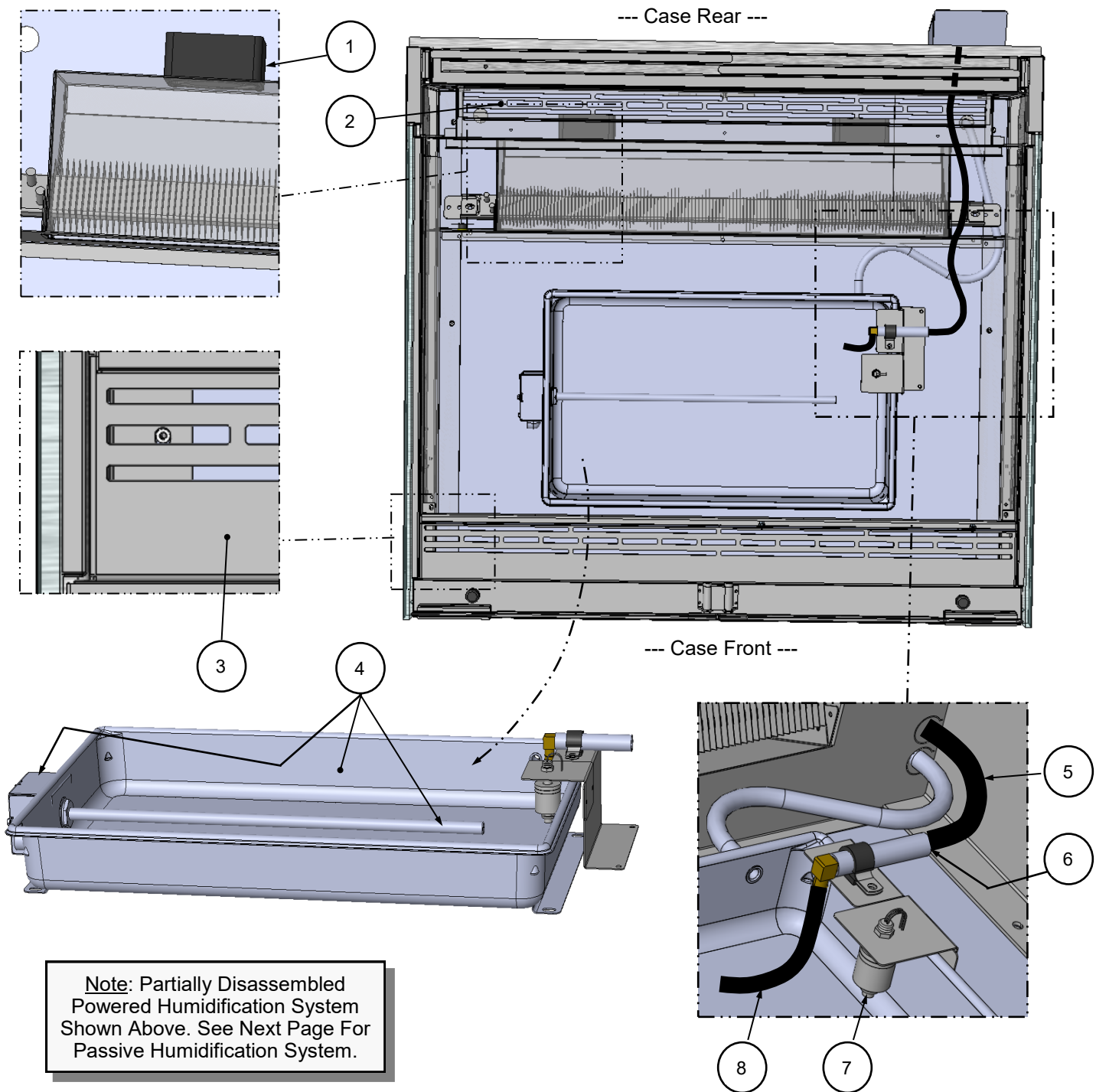

1	Axial Fan Fan (Typ.)	5	Water Inlet Hose From Water Fill Funnel
2	Rear Airflow Baffle	6	Quick-Connect Coupling
3	Front Airflow Baffle	7	Float (Activates Humidification System)
4	Evaporator Pan Assembly	8	Water Inlet Hose From Evaporator Pan Component

Note: Partially Disassembled Passive Humidification System Shown. See Previous Page For Powered Humidification System.

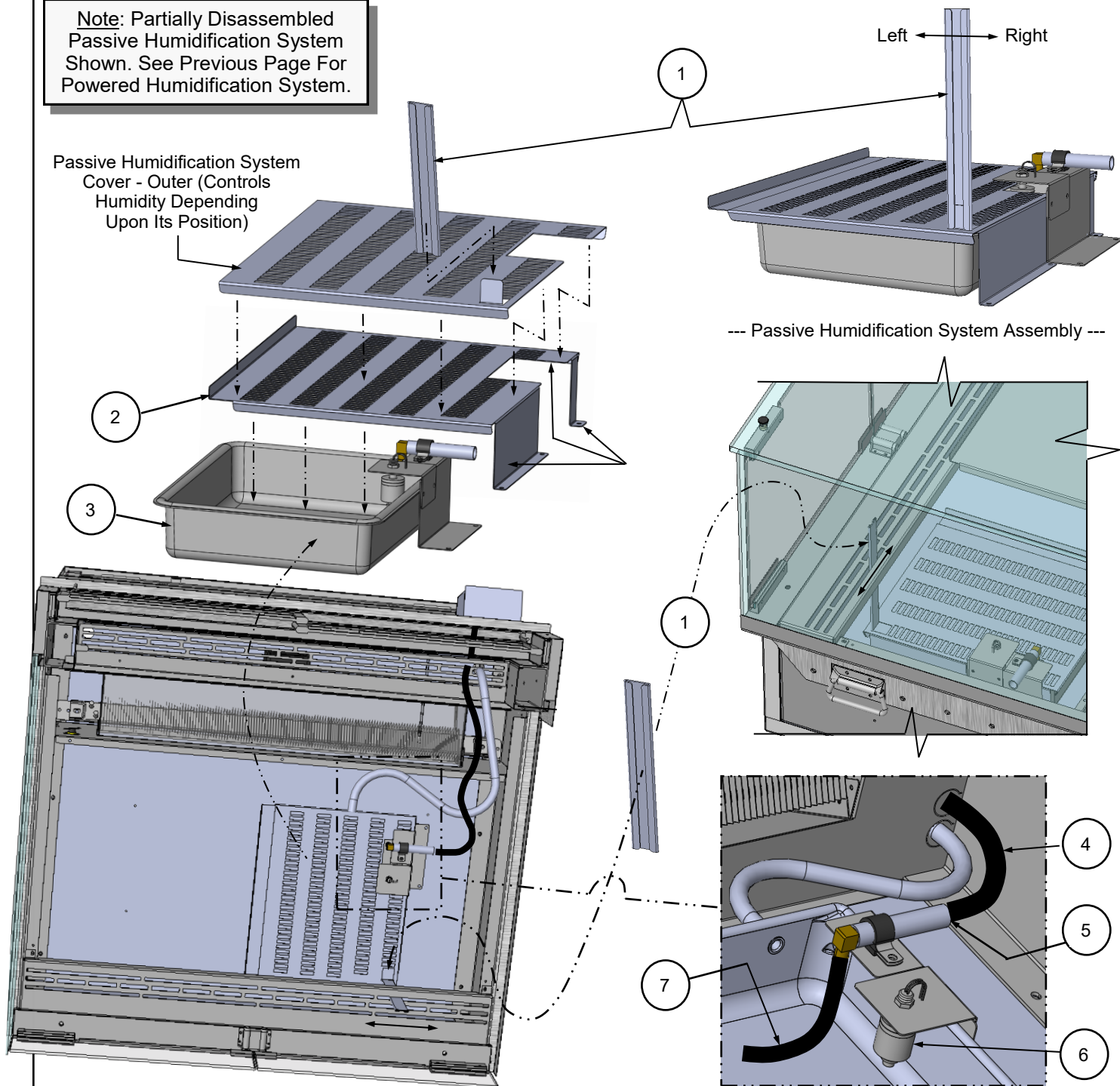

1	Humidification Control Lever	5	Quick-Connect Coupling
2	Passive Humidification System Cover - Outer	6	Float (Activates Humidification System)
3	Passive Humidification System Cover - Inner	7	Water Inlet Hose From Evaporator Pan Component
4	Water Inlet Hose From Water Fill Funnel	8	



Determine Which Programmable Controller Is On Your Case (Controllers That Are Commonly Used By Structural Concepts Are Shown Below). Your Particular Programmable Controller May Differ From Units Shown.



Carel® PJEZ Platform



Carel® ir33 Platform



Carel® iJF Platform



Dixell® XM670K-XM679K Platform

To Access Information About The Programmable Controller That Is Used On Your Case, Follow These Instructions:

- > If Viewing This Document on Smart Phone, Tablet or Computer, Select/Click On The QR Code at Right.
- > If Viewing This Document In Print (Hard Copy), Scan The QR Code at Right With Your Smart Phone or Tablet.

