

BLEND[®] Case Lineup Guide

SCC P/N
21-26284

THIS DOCUMENT INCLUDES LINEUPS OF A VARIETY OF MODELS:
> NM4855RSSV > NM7255DSSV > NM7255HSSV > NM7255RSSV

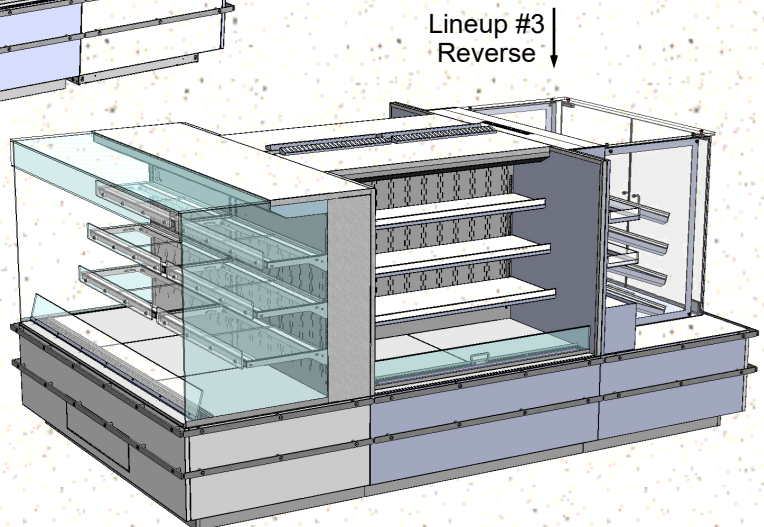
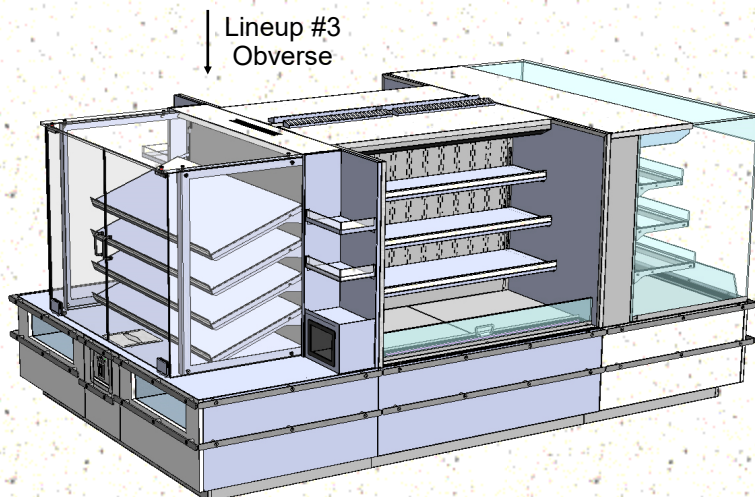
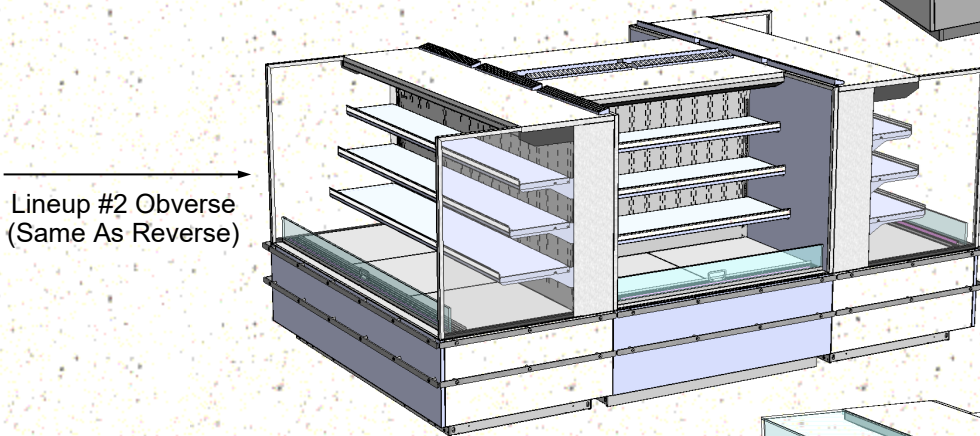
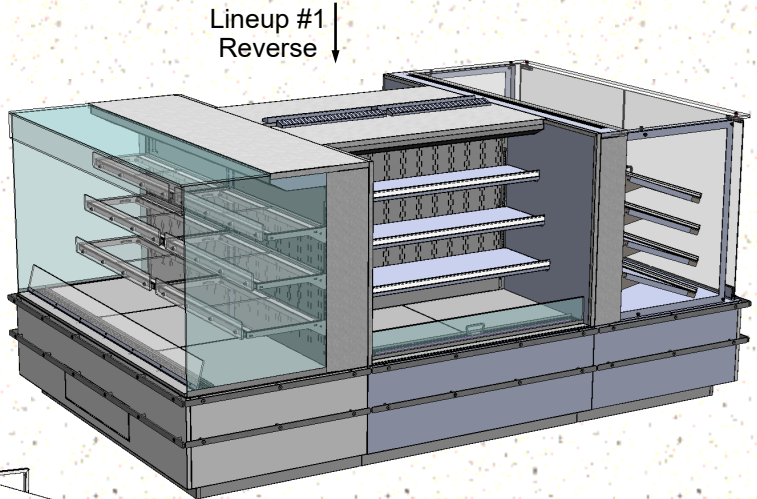
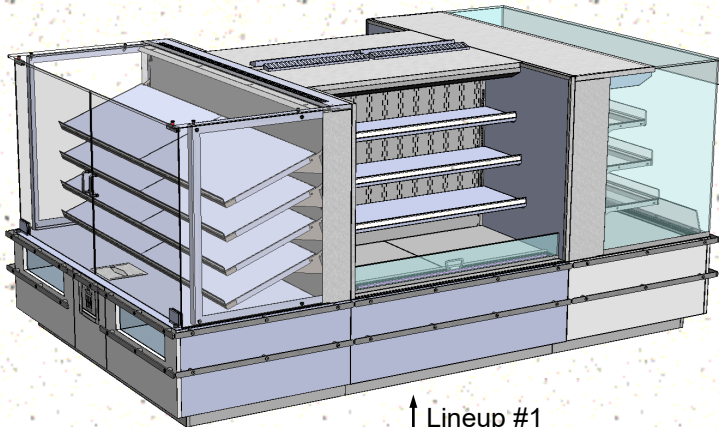

Note: This Guide Is To Accompany
SCC User Guides P/N 21-27948,
P/N 21-27933 and P/N 21-27717.

TABLE OF CONTENTS

TABLE OF CONTENTS	2
COMBINATION OVERVIEW	3
LINEUP #1	4-5
LINEUP #2	6-7
LINEUP #3	8-9
IN-LINE CASE HANDLE REMOVAL / FRONT PANEL ATTACHMENT & ADJUSTMENT ..	10
BOLTING / SEALING / GAP COVER PLACEMENT & TAB BREAK-OFF	11-13

The Blend lineups illustrated throughout this guide represent several lineup arrangements. Many other lineup combinations are available.

Model names identification method:

> **Case Size** - length/height. For example, model NM7255... is 72" long x 55" tall.

> **Temperature Type** - dry (ambient), refrigerated or heated. For example, model NM4855R... represents a refrigerated unit. Model NM7255D... represents a dry (ambient) unit. And model NM7255H represents a heated unit.

> **Access Type** - service vs self-service. For example, model NM4855RSS... represents a self-service unit. Meanwhile, an "...RS..." would represent a service unit.

> **End Panel Glass Style** - angled "A", vertical "V", and curved "C". For example, model NM4855RSSV represents a vertical end glass unit. Meanwhile, NM7255RSSA represents an angled end glass unit.

Illustrations shown throughout this guide may not reflect every feature or option of your particular merchandiser.

Consult the Installation & Operating Manual that accompanies this document for specifics on your particular merchandisers.

Contact Structural Concepts should you wish to consider different layout combinations. Contact information is provided below.

--- --- --- --- ---

Front Panel Lineup Adjustment: Front panel is horizontally adjustable (in and out) via bracket magnets to align front panels to each other during case lineup.

**STRUCTURAL CONCEPTS TECHNICAL
SERVICE INFO:**

1 (800) 433-9490 / EXTENSION 1

DAYS/HOURS AVAILABLE:
MONDAY - FRIDAY (CLOSED HOLIDAYS)
8:00 a.m. TO 5:00 p.m. EST

**PLEASE HAVE THE FOLLOWING
INFORMATION AVAILABLE BEFORE
CONTACTING STRUCTURAL CONCEPTS:**
SERIAL NO. / MODEL NO. / STORE NO. / STORE
ADDRESS / DETAILS (PHOTOS, ETC.)

LINEUP #1

1. Adjoin model NM7255DSSV with NM4855RSSV.
 2. Then, adjoin the other model NM4855RSSV to existing assembly.
- > Lineup instructions continue on next page.

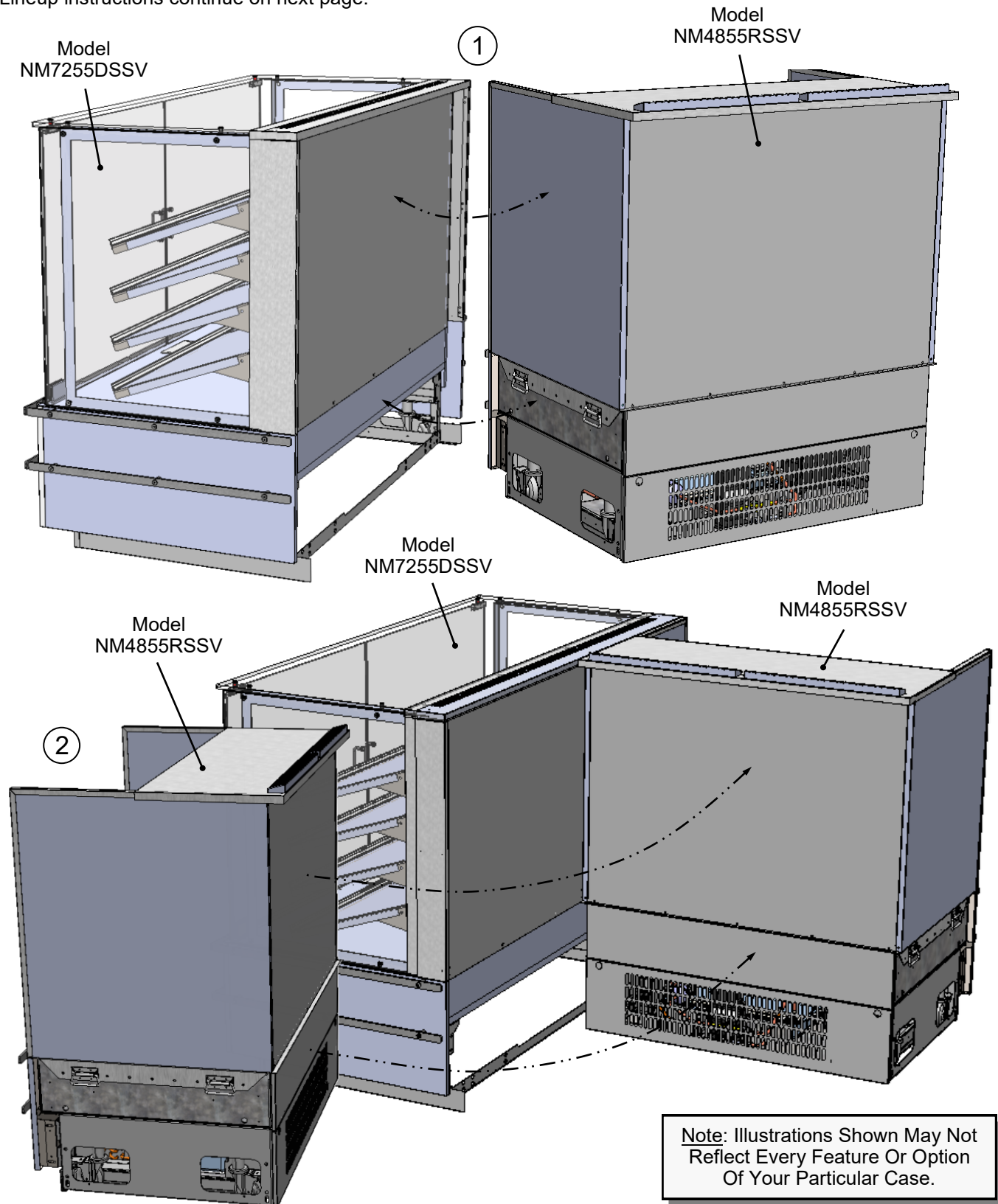

LINEUP #1, CONT'D

3. Lastly, adjoin model NM7255HSSV to existing assembly.
4. Fully adjoined case lineup with models individually listed.

Note: Illustrations Shown May Not Reflect Every Feature Or Option Of Your Particular Case.

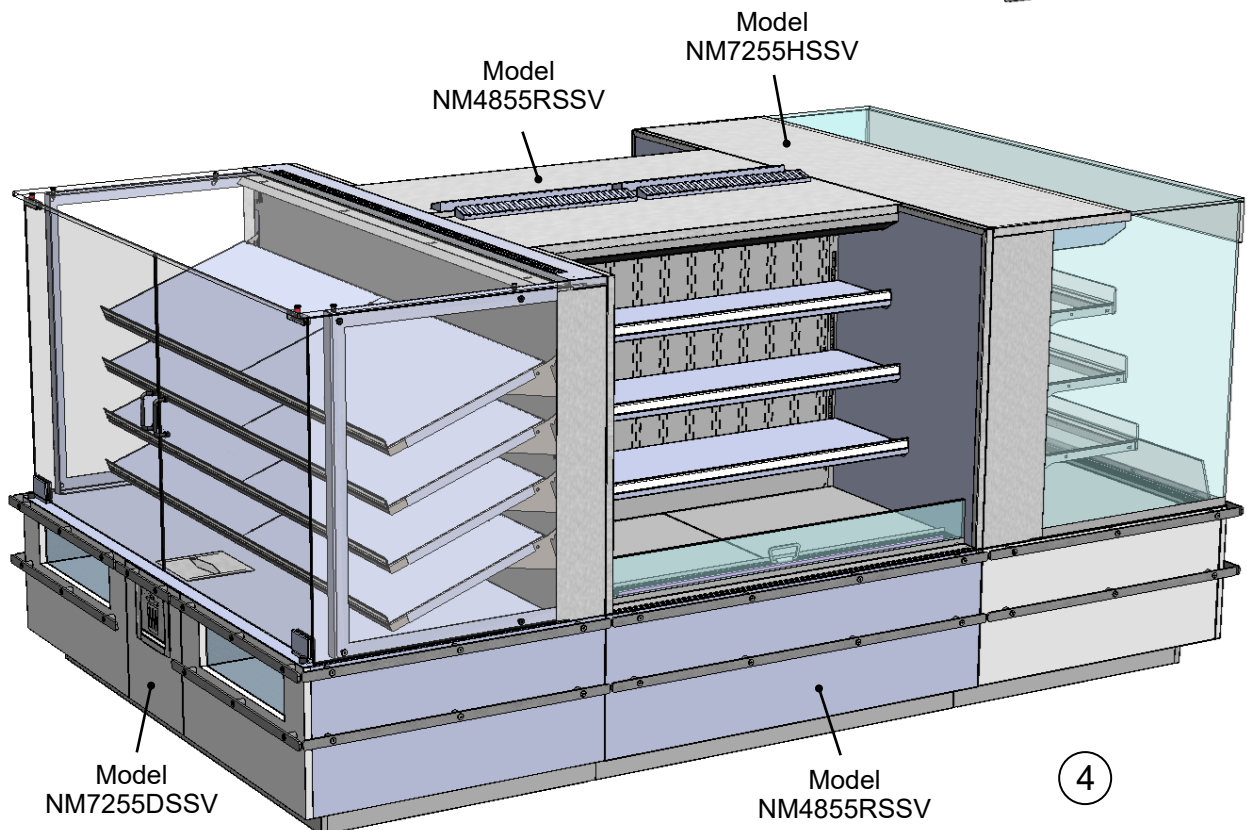
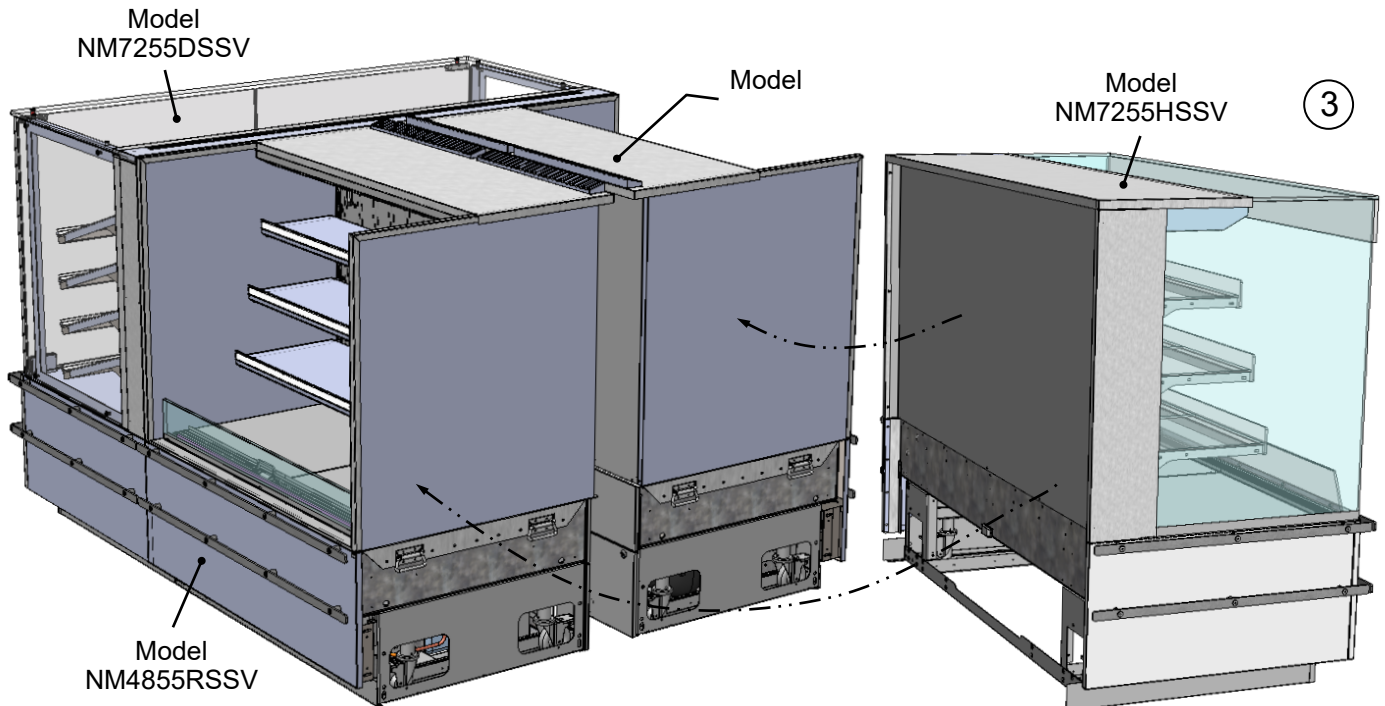

LINEUP #2

1. Adjoin model NM7255RSSV with NM4855RSSV.
 2. Then, adjoin the other model NM4855RSSV to existing assembly.
- > Lineup instructions continue on next page

Note: Illustrations Shown May Not Reflect Every Feature Or Option Of Your Particular Case.

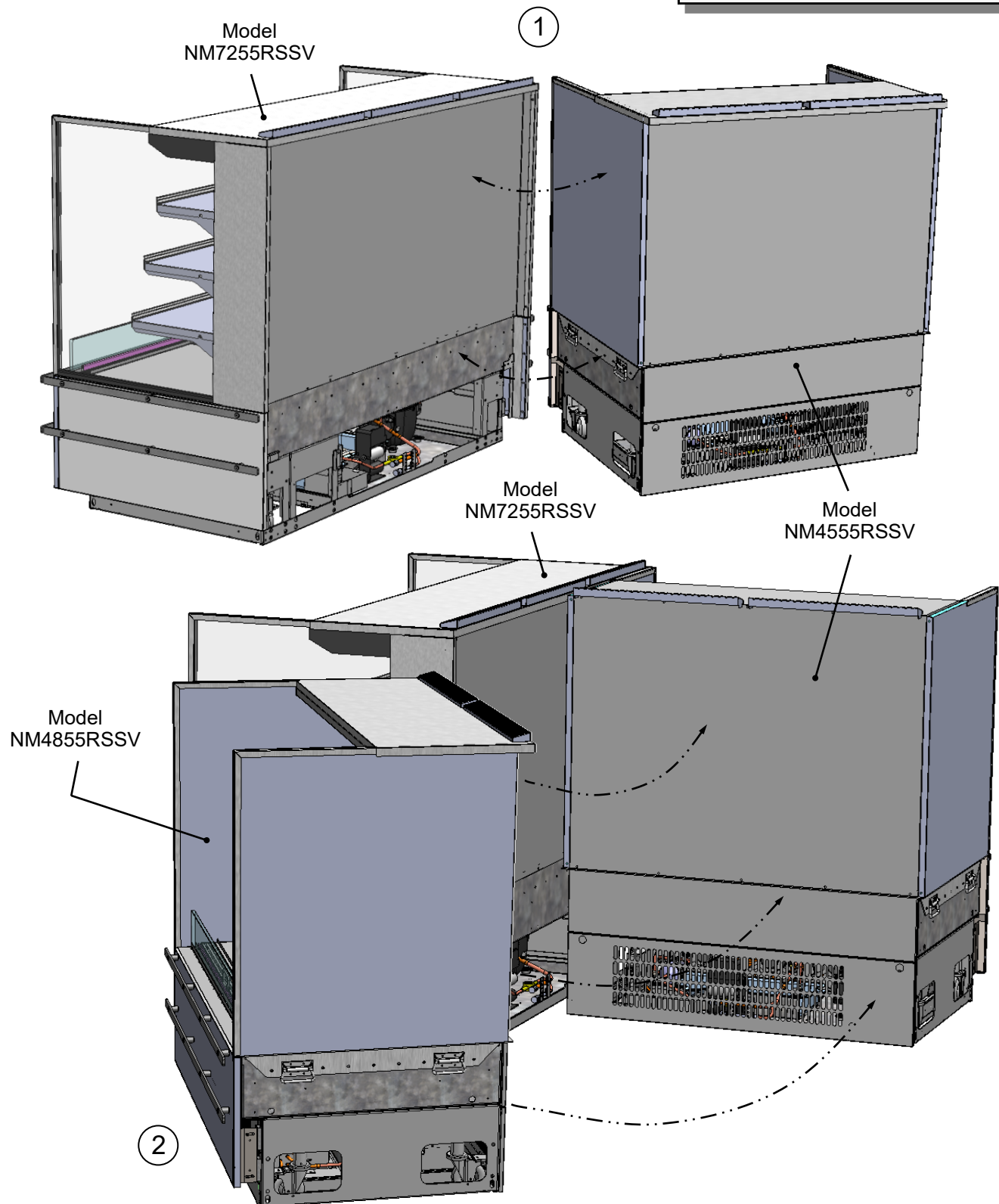

LINEUP #2, CONT'D

3. Adjoin model NM7255RSSV with NM4855RSSV.
4. Fully adjoined case lineup with models individually listed.

Note: Illustrations Shown May Not Reflect Every Feature Or Option Of Your Particular Case.

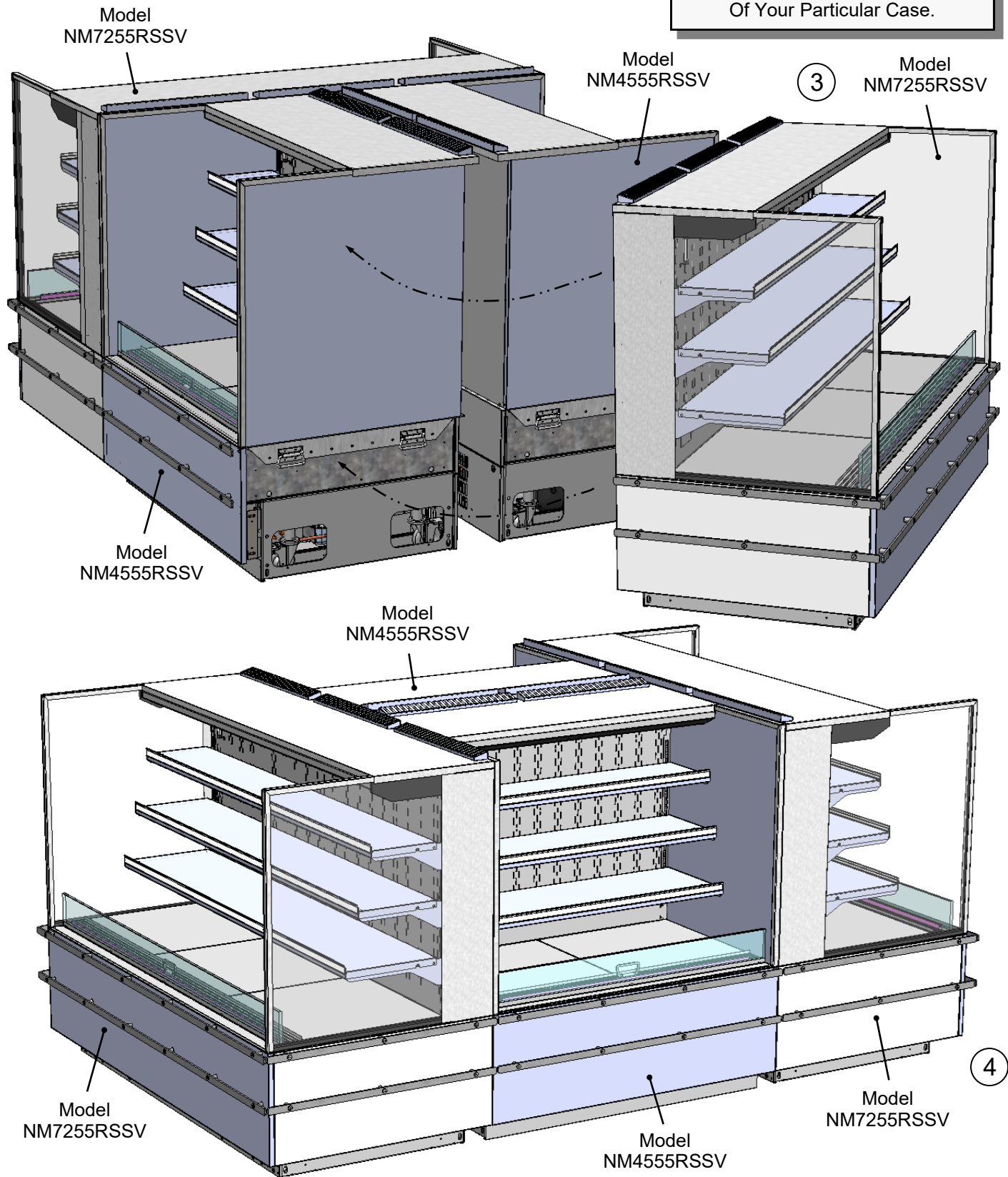

LINEUP #3

1. Adjoin model NM7255DSSV with NM4855RSSV.
 2. Then, adjoin the other model NM4855RSSV to existing assembly.
- > Lineup instructions continue on next page

Note: Illustrations Shown May Not Reflect Every Feature Or Option Of Your Particular Case.

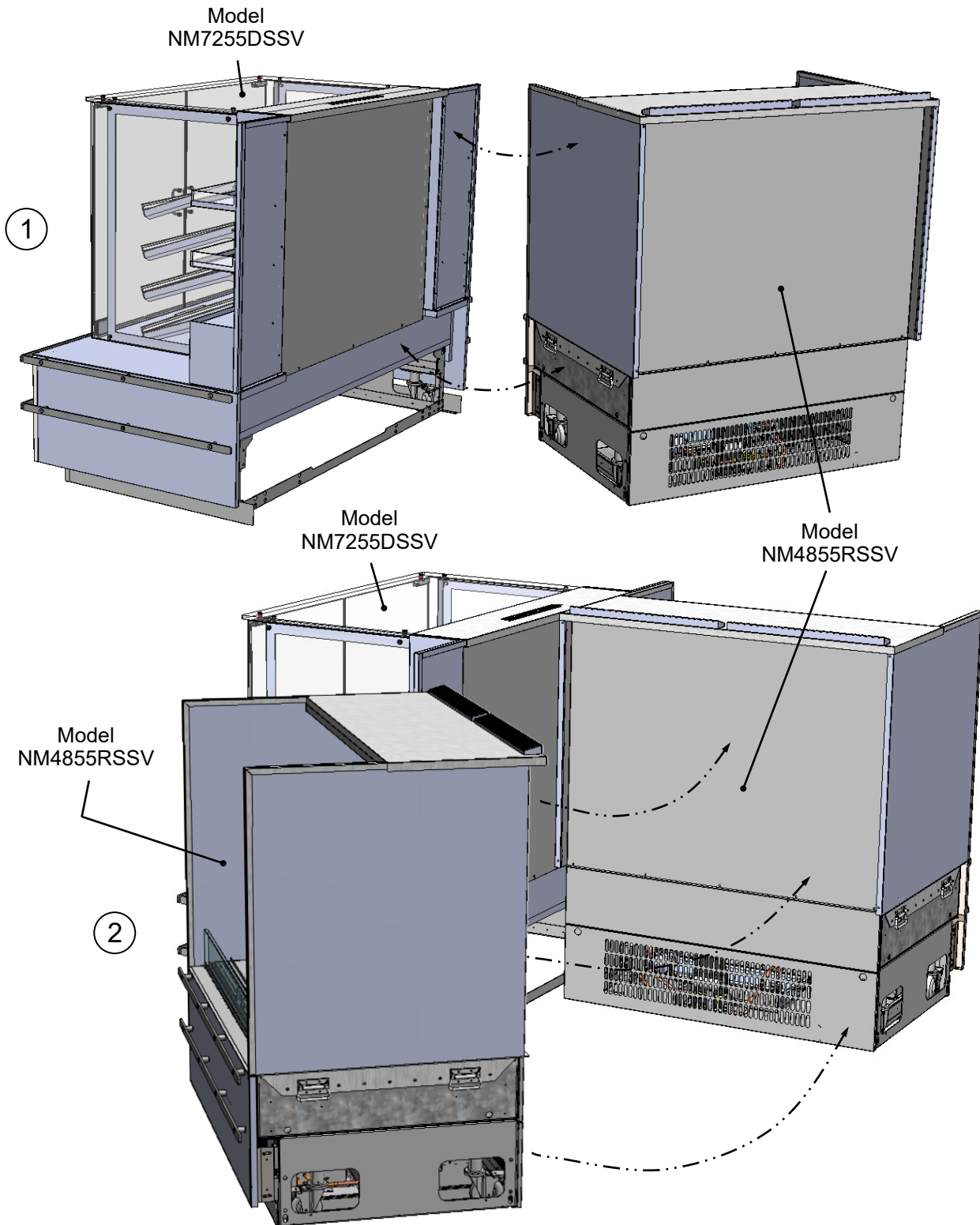

LINEUP #3, CONT'D

3. Adjoin model NM7255HSSV to existing assembly.
4. Fully adjoined case lineup with models individually listed.

Note: Illustrations Shown May Not Reflect Every Feature Or Option Of Your Particular Case.

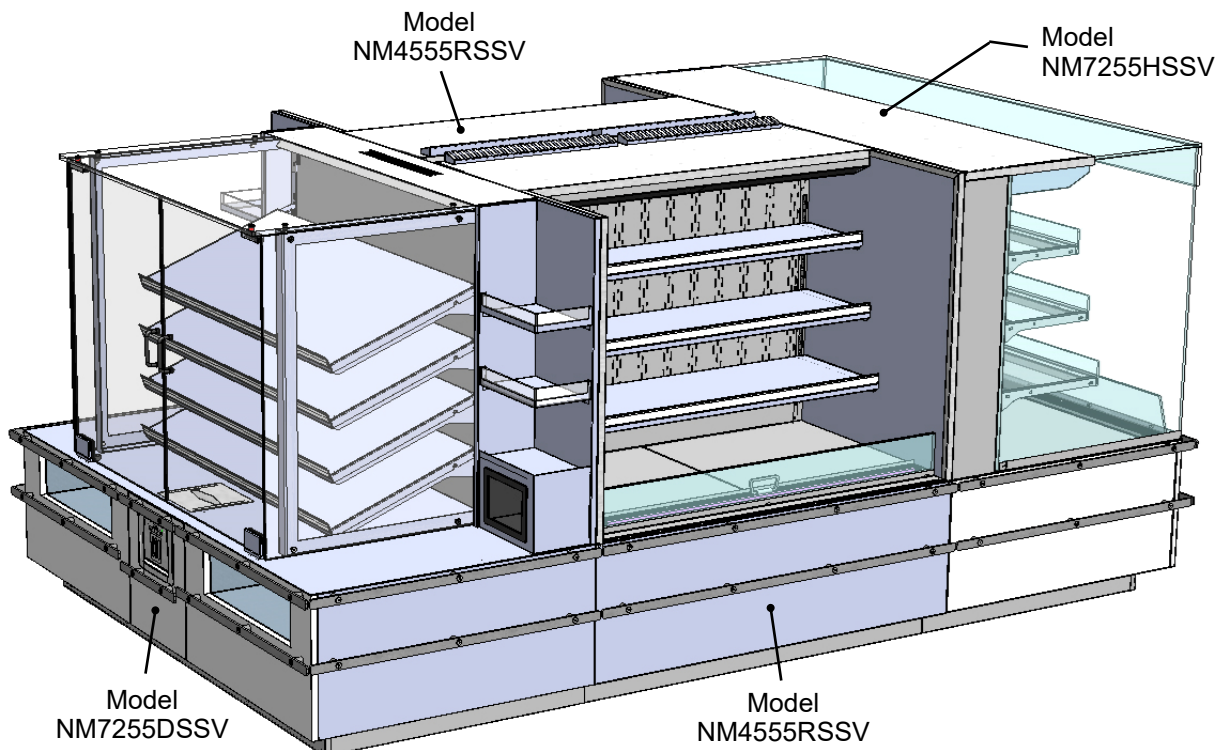
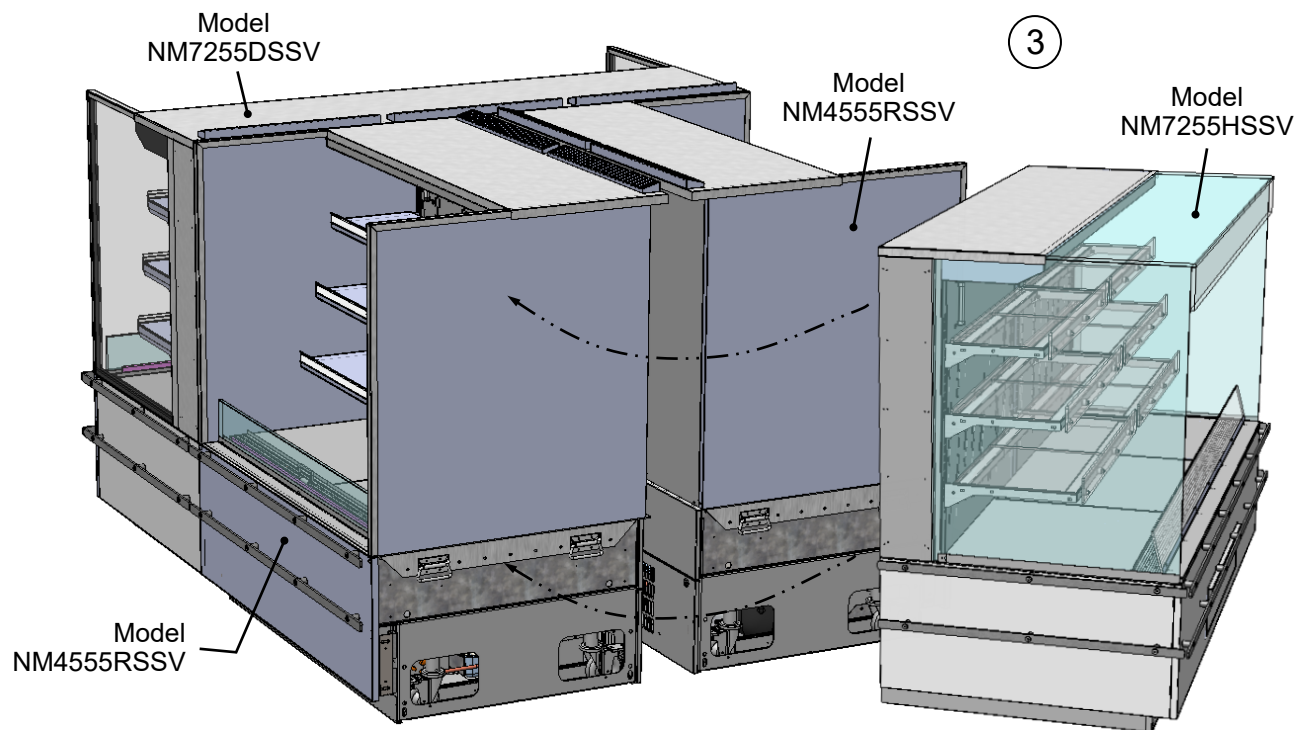

IN-LINE CASE HANDLE REMOVAL / FRONT PANEL ATTACHMENT & ADJUSTMENT

1. Inline Case Handle Removal Front Panel Attachment & Adjustment

- All front panel components may be attached to case via magnets (WITHOUT screw attachments).
- Attach front panel to case (via lower magnets).

2. Inline Case Handle Removal Front Panel Attachment & Adjustment

- All front panel components may be attached to case via magnets (WITHOUT screw attachments).
- Attach front panel to case (via lower magnets).
- Slide front panel horizontal support bracket into case's support slot (line up arrows).
- **Front panel is horizontally adjustable (in and out) via bracket magnets to align front panels to each other during case lineup.**

Note: Model NM725RSSV (Shown)
May Not Reflect Every Feature Or
Option Of Your Particular Case.

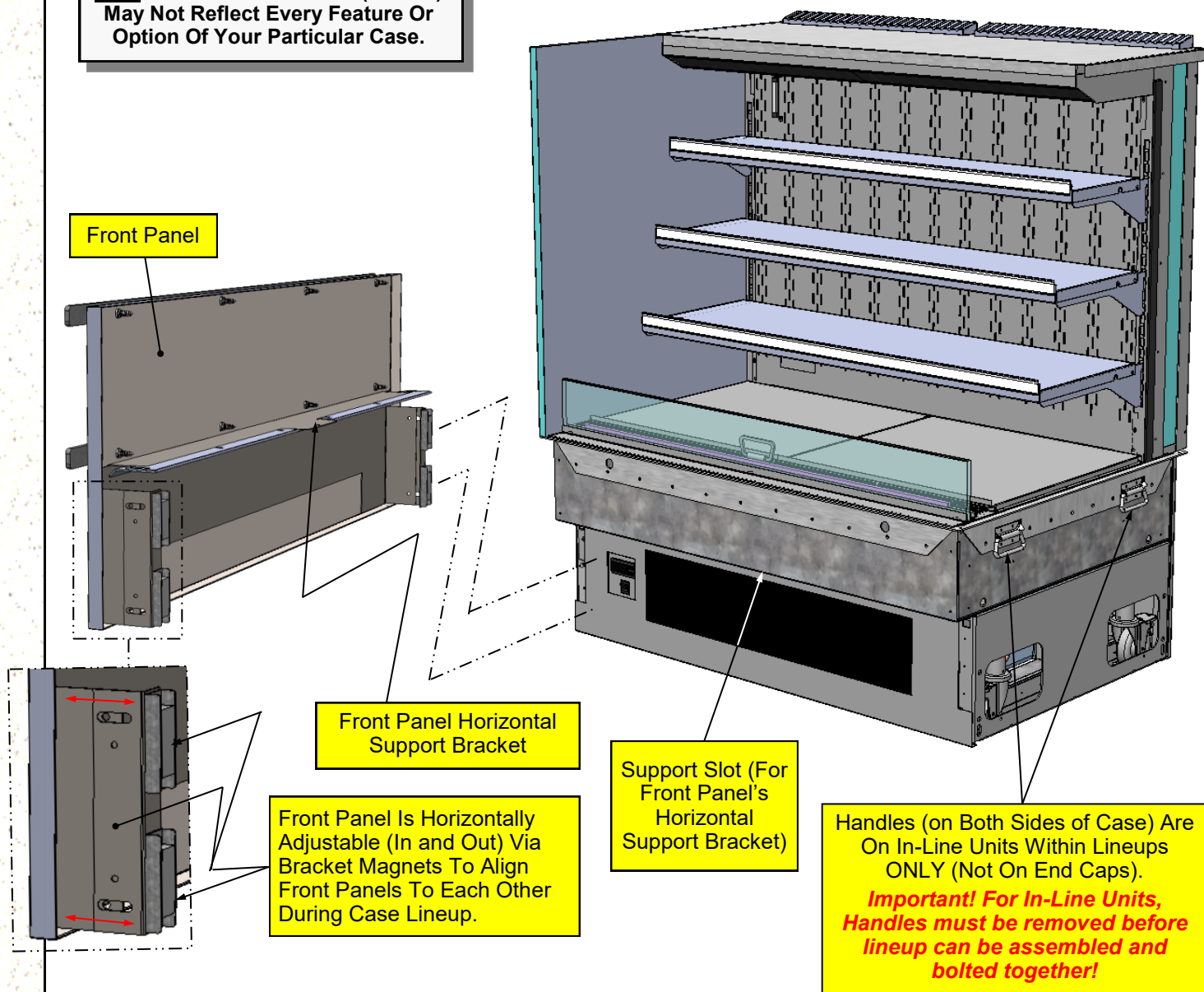

BOLTING / SEALING / GAP COVER PLACEMENT & TAB BREAK-OFF

1. Use brackets, bolts and nuts to join cases together as shown.

- A. To access area to attach adjointment bracketry, you must first remove bracket.
- B. View of brackets that accompany merchandiser during shipment. Four sets likely per assembly.
- C. View of assembled bracket.
- D. Attach assembled brackets to case with bolts (no nuts), at first of four locations) where shown.

- E. Attach assembled brackets to case with nuts and bolts (at second of four locations) where shown.
- F. Attach assembled brackets to case with nuts and bolts (at third of four locations) where shown.
- G. Implement these steps at the remaining three locations on case.

> See next page for **SEALING** instructions.

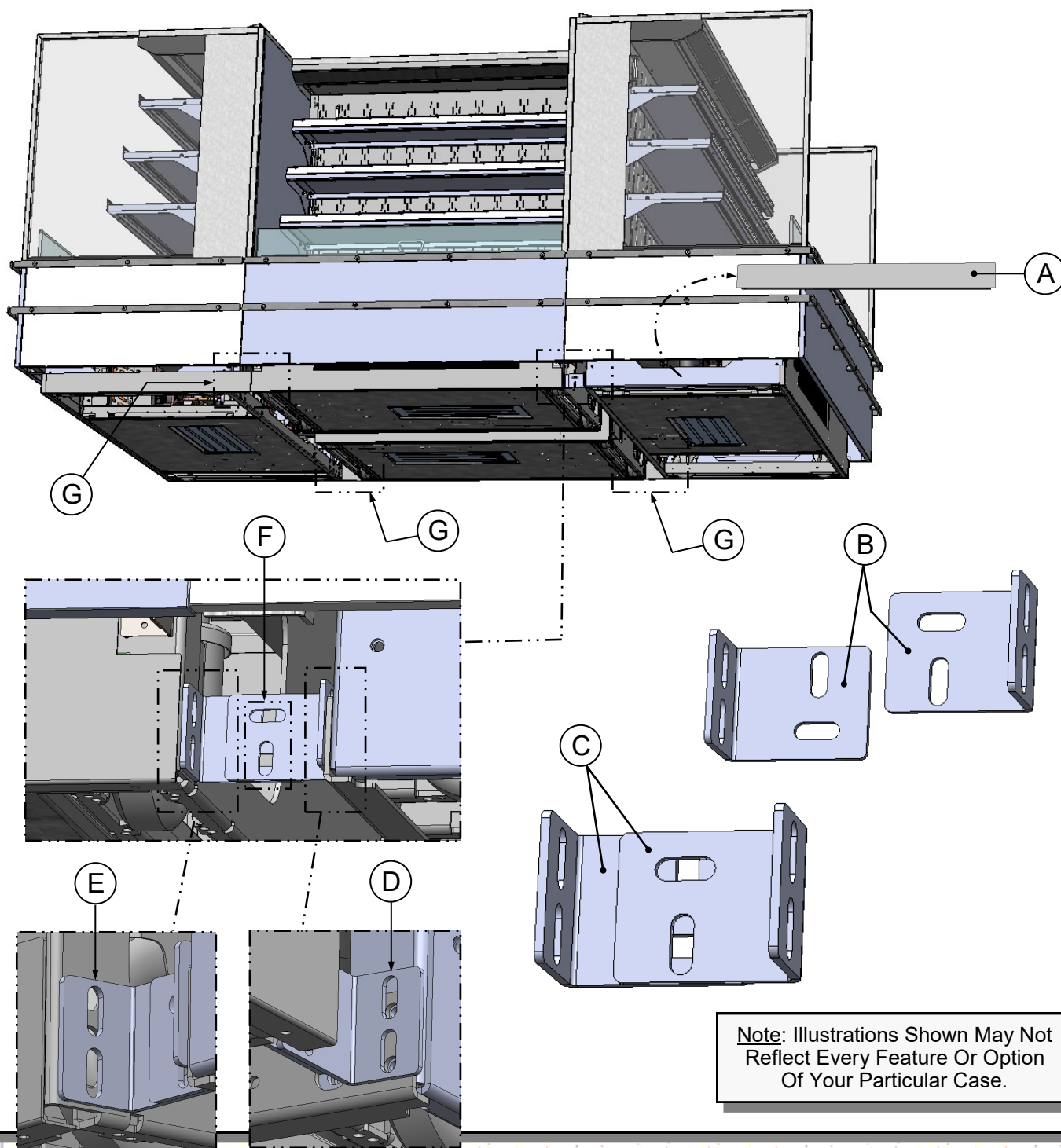

BOLTING / SEALING / GAP COVER PLACEMENT & TAB BREAK-OFF, CONT'D

2. Use SCC-supplied silicone sealant to fill gaps on cases (after they have been securely bolted together).

> Sealant is represented by black dashed lines for illustrative purposes only.

A. Apply a CONTINUOUS bead of SCC-supplied silicone sealant at top adjointment seams of assembly.

B. Apply a CONTINUOUS bead of SCC-supplied silicone sealant at front adjointment seams of assembly.

C. Apply a CONTINUOUS bead of SCC-supplied silicone sealant at rear adjointment seams of assembly.

> See next page for **GAP COVER PLACEMENT** instructions.

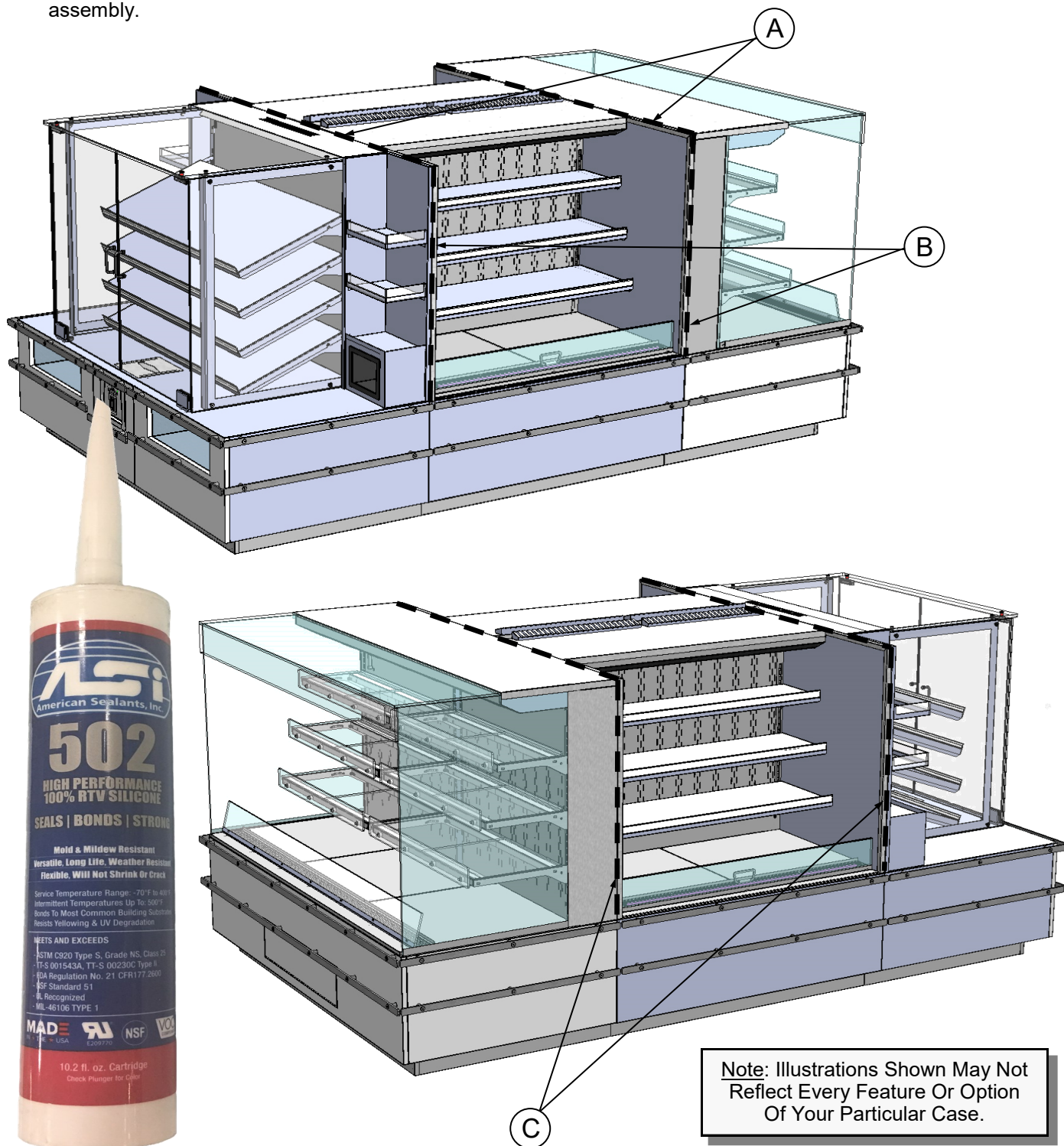

BOLTING / SEALING / GAP COVER PLACEMENT & TAB BREAK-OFF, CONT'D

3. After case has been bolted and sealed, place gap cover at center of assembly.

- > Gap cover is NOT held down with bolts, nor sealed.
- > Gap cover should fit snugly in opening.

- A. View of opening where cap is to be inserted.
- B. View of gap cover to be placed in opening at center of assembly.
- C. Depending upon assembly setup, you MAY need to break off ONE tab at end of gap cover. Carefully

place gap cover on opening to determine if an end tab must be broken off to achieve proper fit. **Caution! DO NOT break off tab at this step in this process.**

- D. If end tab must be broken off to achieve proper fit, break off end tab NEAREST TO the direct wire route that will require wire route tab to be removed. Then, remove wire route break-off tab. If end piece DOES NOT require removal (to achieve proper fit), ONLY BREAK OFF WIRE ROUTE TAB.

> End of retrofit instructions.

